

# EXTENSION LANDSCAPE ARCHITECTURE

## THE IMPACTS OF A STATE-WIDE LEGACY

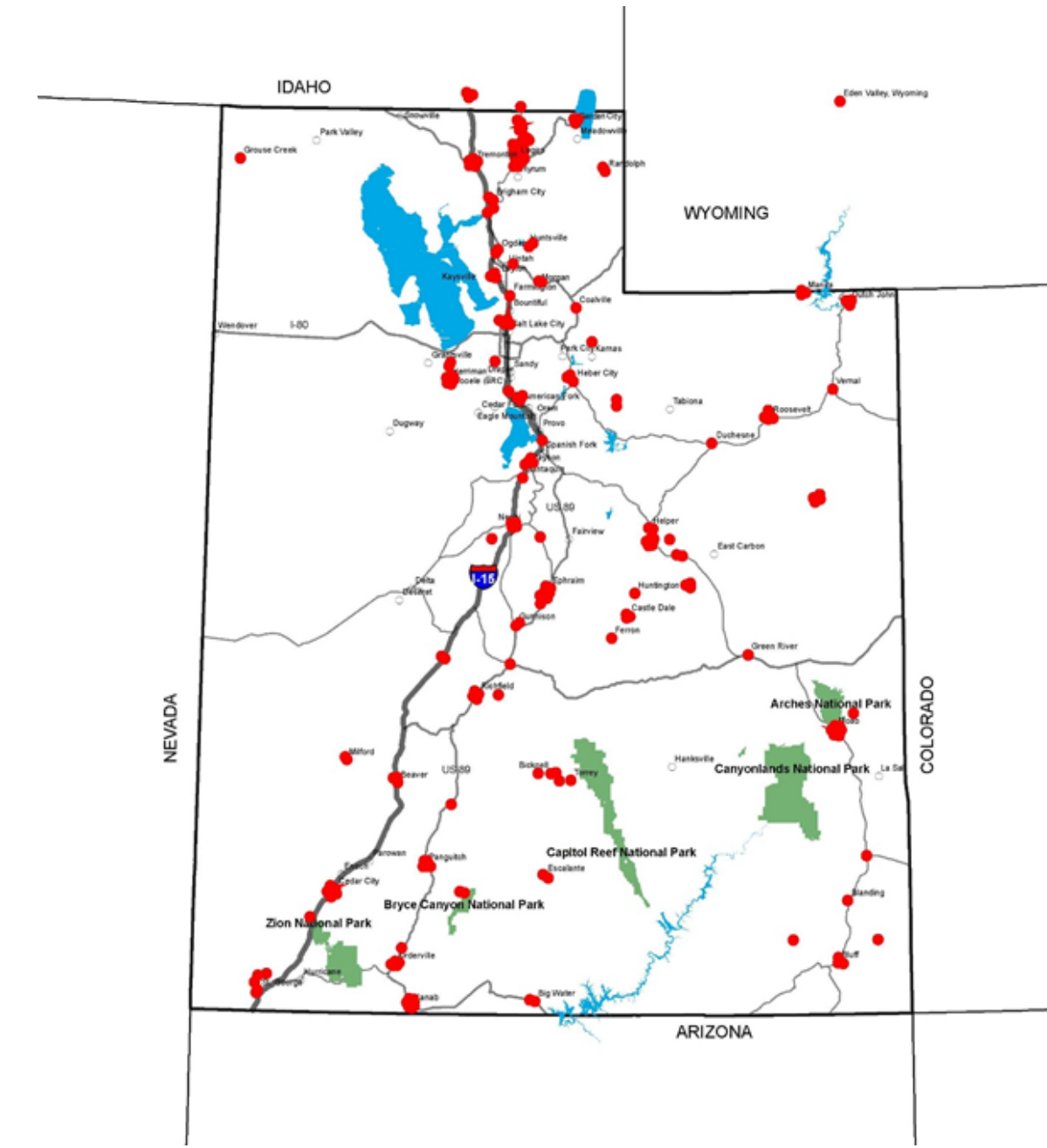

Over the past 45 years, USU's Landscape Architecture and Environmental Planning (LAEP) Department and Extension specialists have engaged Utah's rural communities through a variety of design-based activities. While these projects have contributed to the reputation of USU LAEP as a leader in design-based community engagement, the impacts of these endeavors had not been formally documented, evaluated, or widely disseminated as research products in scholarly venues of landscape architecture or Extension.

This project developed and implemented a model impact assessment framework for evaluating past design Extension projects at USU and guiding future design-based community engagement activities at USU and other land-grant institutions.



EPHRAIM CO-OP

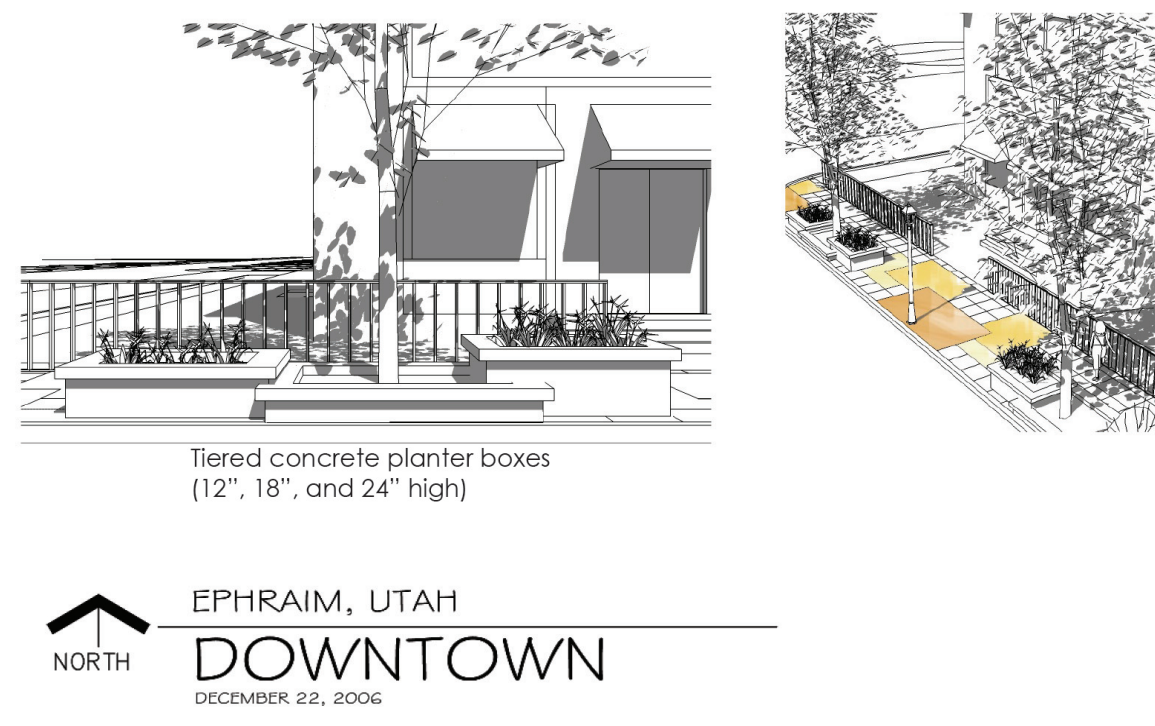
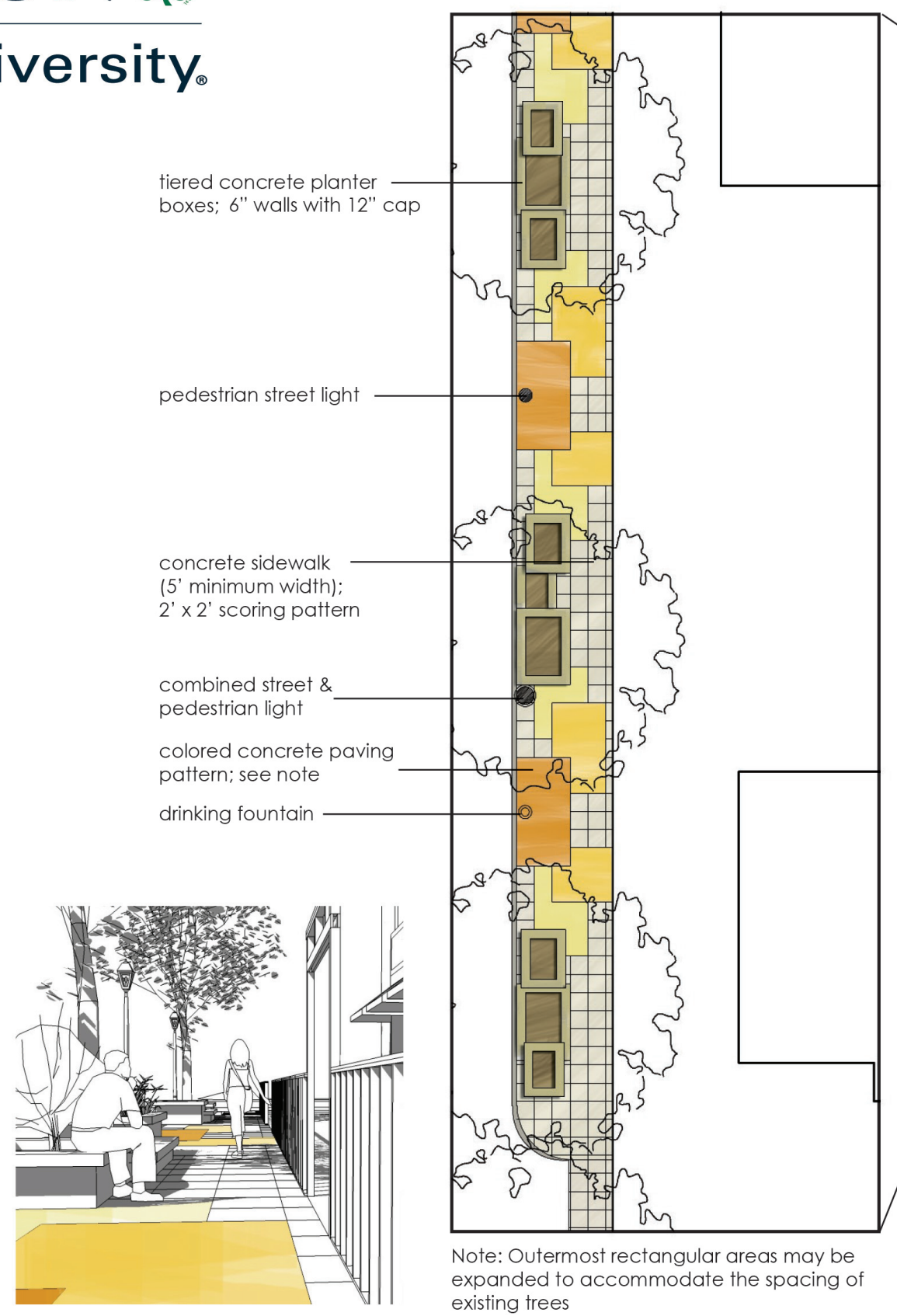

EPHRAIM, UTAH DOWNTOWN

"Between 2006 and 2009, Utah State University, in cooperation with MPNHA, "inventoried" more than 1,000 historical and cultural resources in the Heritage Area that tell the Mormon pioneer story. Those were where much of the energy and many of the resources of the MPNHA would be directed, as outlined in the management plan." (MPNHA, 2016 p.20).

## THE RIPPLE EFFECTS OF LAEP EXTENSION: U.S. 89 PROJECT CASE STUDY



\$2.2 MILLION FROM NPS SEEDS \$44 MILLION IN TOTAL PROJECT EXPENDITURES  
MPNHA SUPPORTED PROJECTS TRANSLATE TO BETWEEN \$57 - \$70 MILLION IN PROJECTS



HERITAGE TOURISM FROM THE MPNHA AVERAGES 185,000 VISITORS PER YEAR



PANGUITCH QUILT WALK PARK

NATIONAL HERITAGE HIGHWAY DESIGNATION

MT. PLEASANT DOWNTOWN



WASTACH ACADEMY MASTER PLAN - MT. PLEASANT

MASTER PLAN SPARKED THE FOLLOWING:  
VISION FOR THE 2011 FUNDRAISING EFFORTS  
6 MAJOR BUILDINGS  
\$13 MILLION IN CAMPUS CONSTRUCTION FEES  
~\$500K IN PROFESSIONAL DESIGN FEES



NAMED UTAH'S MOST BEAUTIFUL SCHOOL BY BUSINESS INSIDER (2018)

U.S. HIGHWAY 89 CHARRETTE

EPHRAIM DOWNTOWN



MANTI DOWNTOWN PLAN

CENTRAL UTAH PIONEER HERITAGE CENTER - MANTI



\$20,000 IN CONSULTING FEES  
\$450,000 IN CONSTRUCTION

CONTROY EQUESTRIAN CENTER



\$1.9 MILLION IN FUNDING FOR CONSTRUCTION

### DESIGN STUDIO PROJECTS



### COMMUNITY DESIGN TEAMS

### PARTNERSHIPS



### CHARRETTES

**60%** LAEP Alumni said:  
LAEP Extension community engagement projects helped connect them with other LAEP alumni and design professionals

**91%** LAEP Alumni said:  
LAEP Extension community engagement projects positively impacted their leadership skills.

**94%** LAEP Alumni said:  
LAEP Extension community engagement projects positively impacted their ability to use the design process to solve real world problems

**68%** LAEP Alumni said:  
LAEP Extension community engagement projects helped them get an internship or a job.

## ASSESSING THE IMPACTS

Archival research identified the program's extensive body of work, comprised of over 300 known projects performed over four decades. During this initial investigation, projects were inventoried, characterized, and cataloged according to project typology, site scale, geographic setting, decade initiated, and level of engagement with departmental faculty, students, community members, and others. From these known projects, 20 projects were selected for further investigation, which included on-site observation and documentation, semi-structured interviews of key project informants, and examination of project impacts within their local and regional contexts. To augment project-specific data, LAEP's alumni and current students were surveyed to determine impacts of design-based community engagement on professional values, career development, and ongoing relationships with the university.

## CASE STUDY SELECTION METHODS WORKFLOW

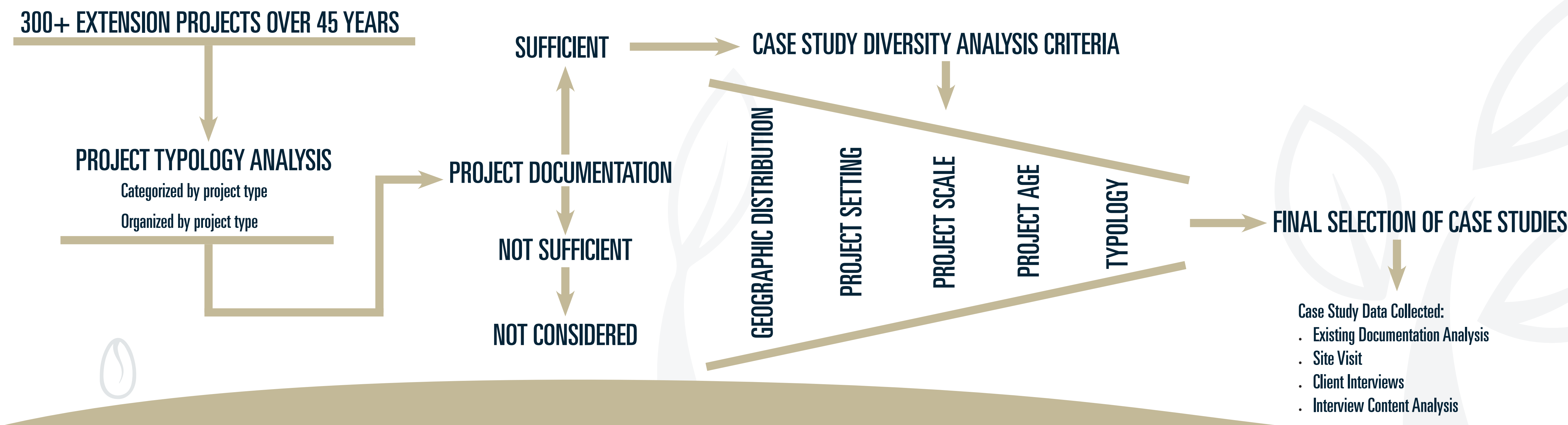

Project Name	Year	Project Type
9-11 Memorial	2013	Parks and Recreation
Cedar City Way finding Plan	2017	Urban Design + Transportation
Central Utah Pioneer Heritage Garden	2012	Landscape + Garden Design
Dutch John Community Planning Project	1995	City + Regional Planning
Eden Valley Habitat Restoration	2014	Restoration + Preservation
Everybody's Playground Master Plan	2005	Parks and Recreation
Heritage Highway, US 89 Charrette	2007	Charrette
Lions Park and Transportation Hub	2017	Parks and Recreation
Manti Downtown Streetscape Plan	2009	Urban Design + Transportation
Moab Technical Education Center Concept Plan	2005	Campus Planning
North Logan Cemetery Master Plan	1999	Parks and Recreation
Ogden Valley Charrette	2014	Charrette
Ondeville Main Street Master Plan	2005	Urban Design + Transportation
Panguitch Quilt Walk Master Plan	2006	Site Design
Panguitch Community Gardens Master Plan	2006	Landscape + Garden Design
Payson Downtown Revitalization Plan	2001	Urban Design + Transportation
Roosevelt Central Park	2016	Parks and Recreation
Tooele Downtown Planning and Design	2006	Urban Design + Transportation
Wasatch County Fair Grounds Master Plan	2006	Parks and Recreation
Wayne County Community Center Landscape Plan	2004	Landscape + Garden Design
San Juan County Regional Plan	2014	City + Regional Planning
Wasatch Academy	2012-16	Campus Planning

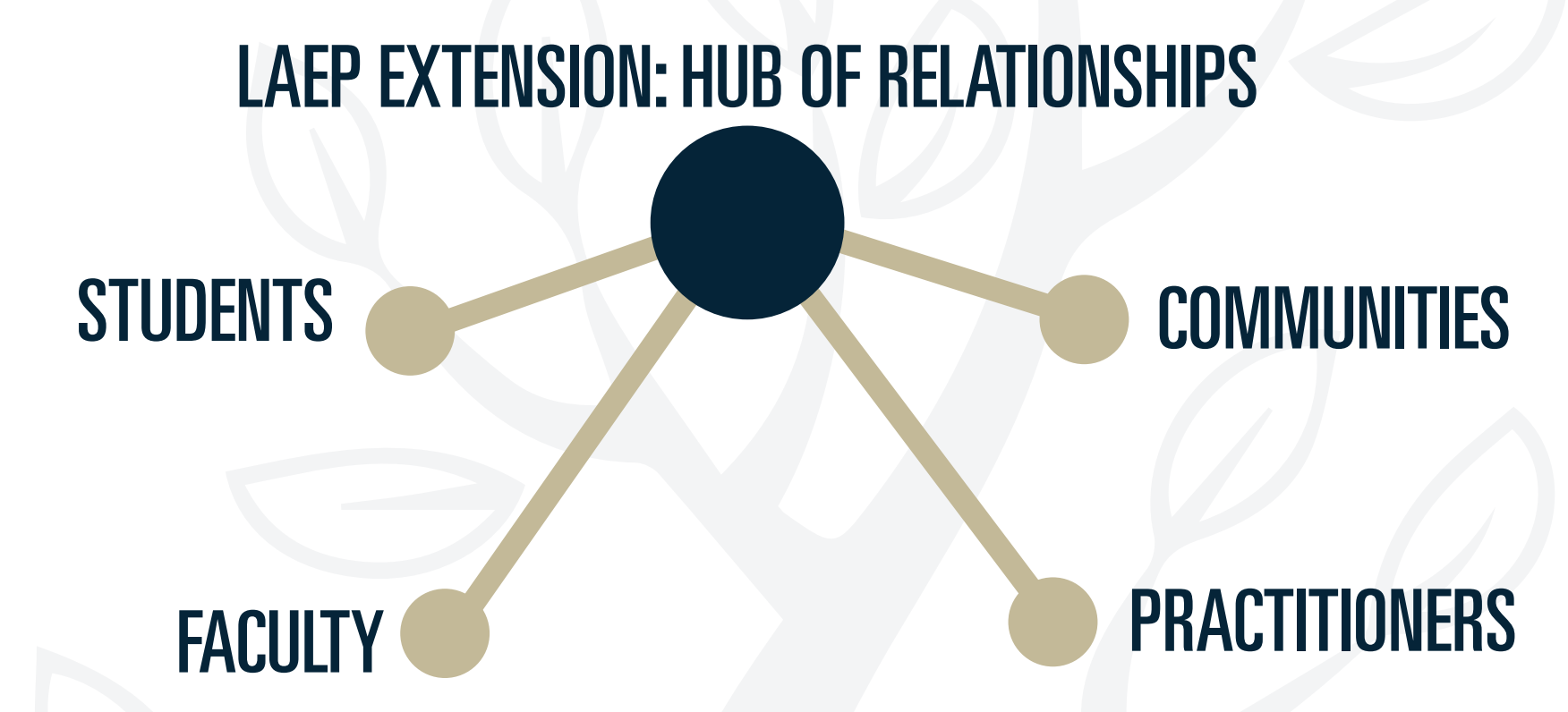

**60%** LAEP Alumni said:  
LAEP Extension community engagement projects positively impacted their ability to collaborate